



**4215 Credit Union Dr.  
Anchorage, AK 99503  
907-274-0770**

**915 30th Avenue  
Fairbanks, AK 99701  
907-458-8912**

**35563 Kenai Spur Hwy.  
Soldotna, AK 99669  
907-260-4433**

**901 N Leatherleaf Lp.  
Wasilla, AK 99654  
907-357-7882**



## **Home Fill Instructions**

# Home Fill Instructions

## Home Fill Placement

- The Home Fill should be located near the concentrator.
- It should be kept away from radiators, heaters or hot air vents.
- Keep Home Fill at least six inches from the wall, drapes or furniture.
- Make sure the Home Fill is off before you plug it into an outlet.
- Outlets should be grounded and extension cords should not be used.
- Avoid deep shag carpet.

## Important Parts of the Home Fill

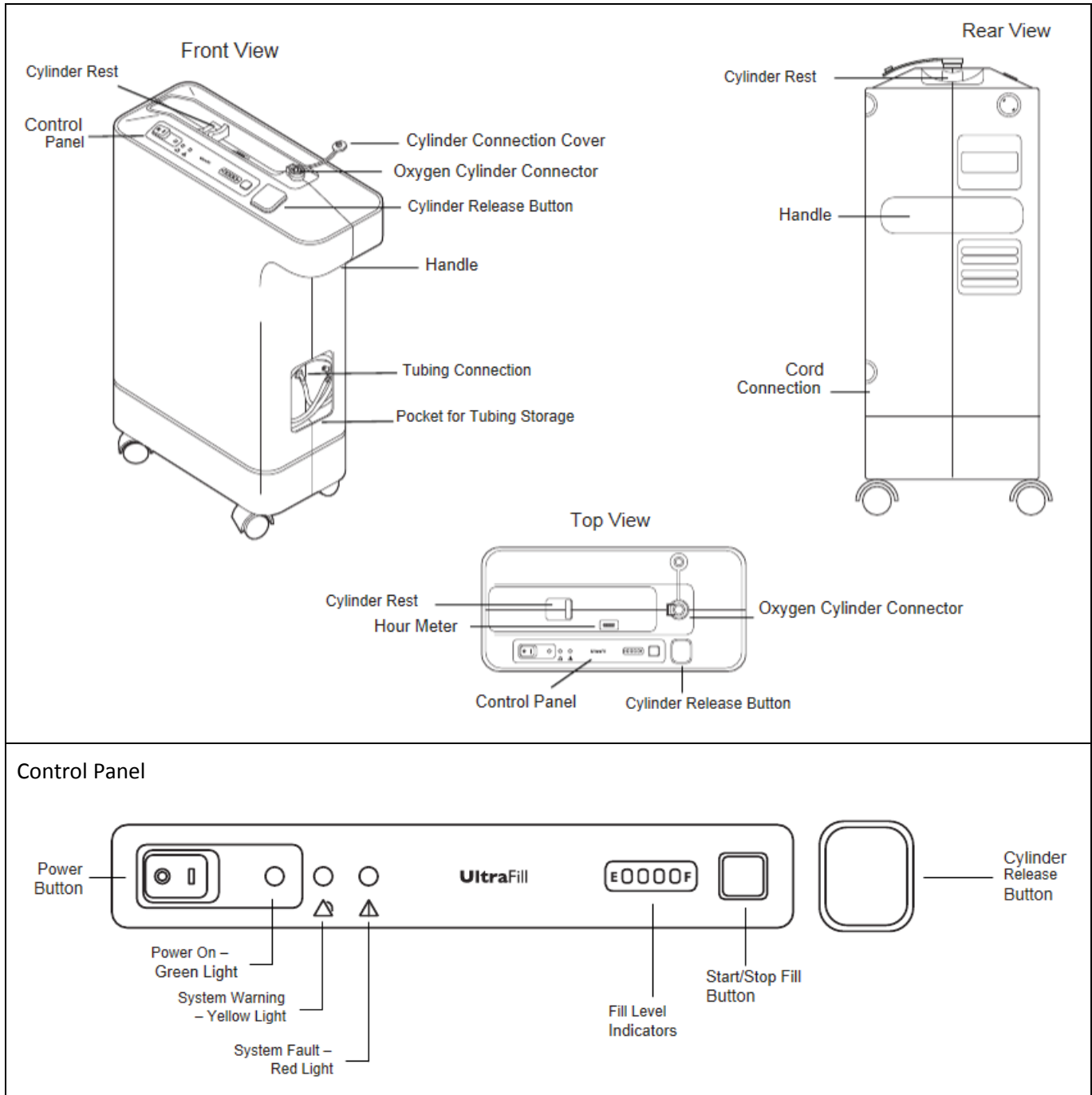

### **Connecting to the Concentrator**

1. Connect one end of the tubing to the home fill outlet connection
2. Connect the other end of the tubing to the concentrator outlet connection.  
Note: Both ends of the tubing are the same.

### **Cylinder Inspection**

1. Check Hydrostatic Test Date.
  - a. Note: Aluminum cylinders require hydrostatic testing every five (5) years.
2. Examine the outside of the cylinder for the following conditions and replace the cylinder if they exist:
  - a. Dents or Dings
  - b. Arc Burns
  - c. Oil or Grease
  - d. Any other signs of damage that might cause a cylinder to be unacceptable or unsafe for use.
3. Examine the cylinder for evidence of fire or thermal damage.
  - a. Blistering of paint
  - b. Damage to protective coating
4. Inspect cylinder fill connection for the following:
  - a. Debris, oil or grease
  - b. Noticeable signs of damage
  - c. Signs of corrosion inside the valve
  - d. Signs of excessive heat or fire damage

Note: Do not use cylinder if any of the above is found, contact Procure for service.

### **Connecting the Cylinder**

1. Ensure the Home Fill and Concentrator are plugged in to the wall outlet.
2. Turn Concentrator on.  
Note: Allow concentrator to warm up five (5) minutes prior to filling a cylinder.
3. Turn on the Home Fill  
Note: the Home Fill will perform a self-check. The red, yellow and green lights will flash and the system will beep. The red and yellow lights will turn off and the green light will remain on when the unit is ready.
4. Set cylinder dial to "OFF" and/or close the cylinder valve.
5. Remove the protective cap from the cylinder connector and fill connector.
6. Line up and place the cylinder fill connector inside the cylinder connector.
7. Press until cylinder "Clicks" into place.

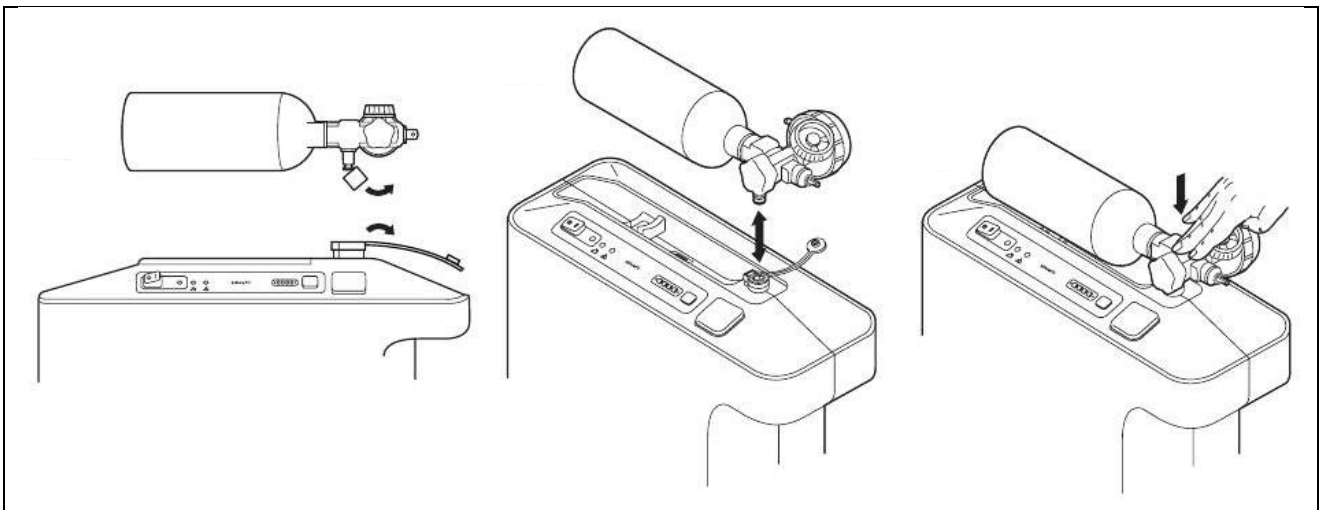

### **Filling the Cylinder**

1. Press the Start/Stop button on the control panel. **(Only Press the Button Once to Start.)**  
Note: As the cylinder fills, the fill indicator on the Home Fill will illuminate. The first indicator blinks while the cylinder is filling, then turns solid when the device is 25% full. As the cylinder continues to fill, each level indicator will blink, then turn solid.  
Note: A cylinder can be removed before it is completely full.

### **Estimated Fill Times**

<b>2000 PSI Cylinder</b>	
<b>Cylinder Size</b>	<b>Estimated Fill Time</b>
E	5 hr
D	3 hr
M9 / C	2 hr
M6 / B	1 hr

<b>3000 PSI Cylinder</b>	
<b>Cylinder Size</b>	<b>Estimated Fill Time</b>
E	7.5 hr
D	4.5 hr
M9 / C	2.5 hr
M6 / B	1.75 hr

### **Removing the Cylinder**

1. Press the cylinder release button on the control panel. The cylinder will disconnect and the fill level indicators will turn off.
2. Lift up on the cylinder to remove from the oxygen fill connector.  
Note: Oxygen will escape from the fill connector for a short time after the cylinder has been removed. This may be accompanied by a “pop” with a rush of air. This is normal.
3. Put the protective cap on the cylinder connector and fill connector.

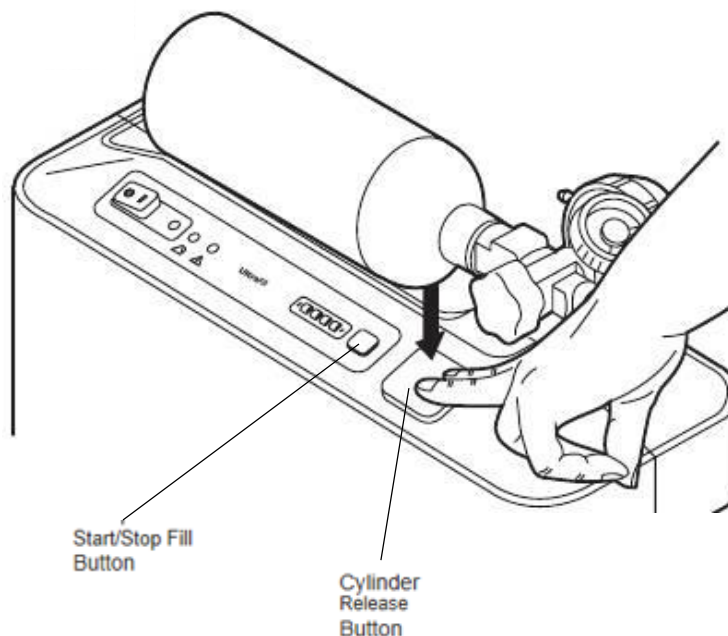

## **Alarms / Trouble Shooting**

<b>Problem</b>	<b>Possible Cause</b>	<b>Possible Solutions</b>
Cylinder is connected but there are no indicator lights on.	Cylinder is not fully connected.	<ol style="list-style-type: none"> <li>1. Press the disconnect button.</li> <li>2. Verify there is no obstruction to the cylinder fill connection.</li> <li>3. Reconnect the cylinder to the home fill.</li> </ol>
Cylinder is connected and there is at least one indicator lights on, but fill will not start.	Cylinder is not fully connected.	<ol style="list-style-type: none"> <li>1. Press the disconnect button.</li> <li>2. Verify there is no obstruction to the cylinder fill connection.</li> <li>3. Reconnect the cylinder to the home fill.</li> </ol>
Yellow LED is blinking	Incorrect pressure from the concentrator or the cylinder valve is open.	<ol style="list-style-type: none"> <li>1. Verify that the concentrator and home fill are connected.</li> <li>2. Check for kinked tubing.</li> <li>3. Verify that the cylinder valve is closed.</li> </ol>
Yellow LED is illuminated	The home fill has detected low oxygen purity.	<ol style="list-style-type: none"> <li>1. Press the start/stop button.</li> <li>2. Check the flow meter on the concentrator to verify the flow does not exceed the following:               <ol style="list-style-type: none"> <li>a. 3 LPM on a 5 LPM Concentrator</li> <li>b. 7 LPM on a 10 LPM concentrator</li> </ol> </li> </ol>
Red LED is illuminated and alarm is sounding	The device has detected a system malfunction.	<ol style="list-style-type: none"> <li>1. Remove the cylinder.</li> <li>2. Turn off the home fill device for at least five (5) minutes.</li> <li>3. Restart the device and attach cylinder.</li> </ol>

### **Cleaning**

- Filter(s) located on the side/back of the cabinet should be checked weekly and cleaned when dirty.  
Note: Filter(s) should be cleaned at least once a week.
- Wipe cabinet with a damp cloth if necessary.
- Aluminum cylinder must have hydrostatic testing every five (5) years.

### **Routine Delivery**

- We encourage patients to pick-up cylinders and supplies at Procure Home Medical. The intent is to promote mobility, exercise and a healthy lifestyle. Patients may also call to schedule delivery, supplies or maintenance Monday through Friday 8:30 am - 5 pm. Weekend deliveries are provided in emergency situations only. Please allow 4 hours for delivery.

### **Maintenance**

- Procure Home Medical schedules routine maintenance checks following manufactures recommendations on oxygen equipment. Service Technicians will call in advance to schedule services with you.  
Note: Home Fill units are inspected at the same time you concentrator.